

Guidance Specification

Plinths

General

Ensure that double or multiple concrete supports are constructed to such a height to allow adequate access both for the Waterproofing Contractor at the time of installation and for cleaning and maintenance at some future date. Plinths or bases built on the waterproofing membrane are to be placed on an additional layer of Derbigum SP4 and not directly to the waterproofing membrane.

Specification

One layer Derbigum SP4 fully sealed (as described for roof areas), up and over plinths with a sheet metal capping detail over the plinths to serve as protection to the membrane. Allow sufficient height for maintenance purposes (600mm).

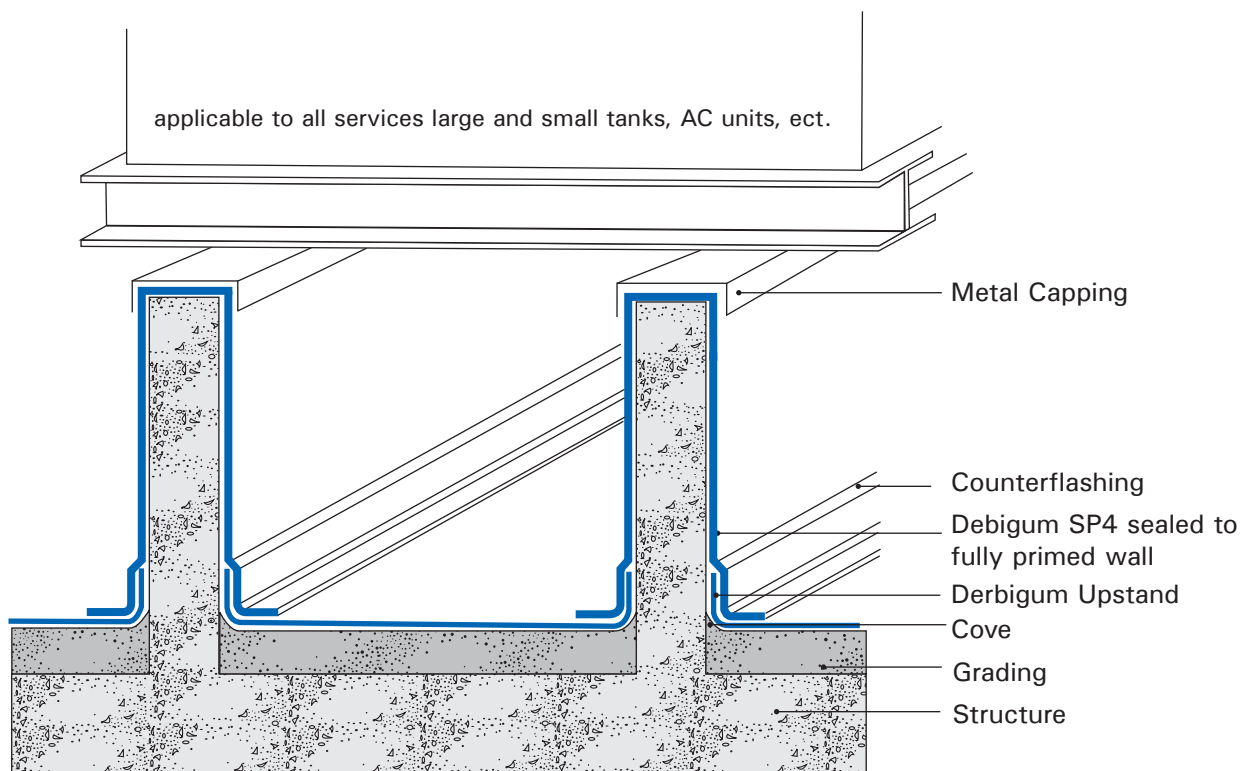

Derbigum Manufacturing (Pty) Ltd. accepts no responsibility for accuracy of any typical / guidance details or drawings or specifications contained herein. These specifications and details are not to scale and are intended only to be used as a guideline. For more detailed specifications please contact your nearest branch.